

Construction Manual for CERARL: General Substrate

- Before construction, read the Construction Manual carefully for correct work.
- Be sure to hand the Instruction Manual included in the package to the client.
- Before construction, identify the part No. and check for damage and scratches which may be given during transportation. Note that we will not take responsibility for subsequent damage or defects.
- Construct the product in accordance with laws and regulations such as the Building Standards Act and the fire prevention ordinance of your own country.
- CERARL expands or contracts depending on change of environments.
Be sure to contract in accordance with the standard construction methods and precautions.
- This product cannot be used for wall surfaces of bathrooms or facilities where use a great amount of water.
- CERARL front surface is on the face where the protection film/part No. label is pasted.
- Do not construct the product on the moistened foundation, on the foundation having possibly to become moist after construction or in the place that will become hot and humid. (This may cause peeling.)
- At delivery, two or more workers are required to carry CERARL in the construction field because the product warps during transportation.
- Do not construct CERARL in the environment of 5°C or lower temperature. (Adhesive agent may be defectively hardened.)
- Be sure to ventilate in the period of curing during and after construction.
- For the special adhesive agent, antibacterial, antifungal silicone and special primer, check the detail safety information at each SDS.
- This product is for industrial use and for business operators. Dispose the product as industrial waste, if required. (CERARL/ waste plastic, protective film/ waste plastic, corrugated cardboard cases/paper)



Safety precautions

The following precautions are given to prevent injury and accidents. Be sure to observe them.

Precautions	Expected Risks
<ul style="list-style-type: none"> ● Do not use any temporary tacking tape or adhesive agent other than the designated special ones. ● Strictly observe the construction method of foundation designated by the material manufacturer. 	<p>Possibility to fall due to peeling</p>
<ul style="list-style-type: none"> ● Keep domestic heating cooking apparatuses away from the surface of CERARL at a sufficient distance. For details, see Page 4. ● As industrial heating cooking apparatuses have an extremely high calorific value compared to the ones for domestic use, we cannot use CERARL closed to them. 	<p>Possibility of discoloration on surface</p>
<ul style="list-style-type: none"> ● During transportation and work, wear a pair of non-skid gloves. Also, wear a protective mask and protective glasses to protect dust generated at processing. Use a dust-proof circular saw in a well-ventilated working environment. If dust adheres to your skin or it is involved in your eyes, nose or mouth, immediately wash it fully off with water. If you feel something strange in yourself, receive medical treatment immediately. ● You may cut your hand with the cutting/processing edges. Be sure to chamfer the edges using sandpaper. ● Some designated special adhesive agent or primer to be used may contain organic solvent. Be sure to fully ventilate and take special care on fire when using them. 	<p>Possibility of injury or health disorder</p>

Construction procedure

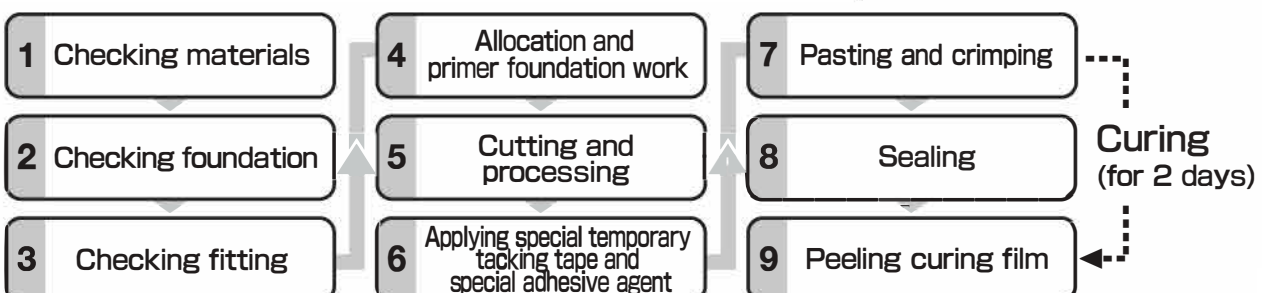

CERARL Spec

Item	Size(mm)	Packing
CERARL	3×9:t3×935×2,755	1sht/ctn
	4×8:t3×1,235×2,455	1sht/ctn
	3×8:t3×935×2,455	2sht/ctn
	3×6:t3×935×1,855	2sht/ctn
	910×2,420:t3×910×2,420	2sht/ctn

Related Materials		Size	Standard Applying Qty	Packing		
Application Kit (3type is available)	Special adhesive 333ml/pc		1pc = for 3'x8' 1sht 1.3pc = for 4'x8' 1sht	2pcs	3pcs	2pcs
	Special temporary tacking tape		1roll = for 3'x8' 1sht 1.4roll = for 4'x8' 1sht	2rolls	3rolls	2rolls
	Package with silicone	Antibacterial, antifungal silicone 320ml/pc	1pc = for 12~15m	—	—	1pc
		Masking tape	—	—	—	1roll
Antibacterial, antifungal silicone (JK-57□)		320ml/pc	1pc = for 12~15m	10pcs/case x 2		
Special temporary tacking tape		t1mm x w20mm x 10m /roll	1roll = for 3'x8' 1sht 1.4roll = for 4'x8' 1sht	5rolls·40rolls		
Special adhesive	SE-1	333ml/pc	1pc = for 3'x8' 1sht 1.3pc = for 4'x8' 1sht	20pcs/case		
Special Primer *1	Solvent type (JW-900N)	1kg/csn	1kg = for 3'x8' 3~4sht 1kg = for 4'x8' 2~3sht	2cans/case		
	Water type (RA-900)	2kg/csn	1kg = for 3'x8' 9~11sht 1kg = for 4'x8' 7~8sht	1can/case		
Subsidiary materials	Alumium	Flat joint	L=3,075 mm	—	2pcs·20pcs/case	
		Edge/Internal corner	L=3,075 mm	—	2pcs·20pcs/case	
		External corner	L=3,075 mm	—	2pcs·20pcs/case	
		Internal corner	L=3,075 mm	—	2pcs·20pcs/case	
		Decorative external corner	Corner angle 90° L=2,430mm	—	2pcs·5pcs/case	
			Corner angle 135° L=2,430mm	—	order-made item	
		Almium hat type joiner	L=3,075 mm	—	2pcs·20pcs/case	
	ABS	Flat joint	L=3,075 mm	—	2pcs·20pcs/case	
		Edge/Internal corner	L=3,075 mm	—	2pcs·20pcs/case	
		Horizontal edge	L=3,075 mm	—	2pcs·20pcs/case	
		External corner	L=3,075 mm	—	2pcs·20pcs/case	
		Special baseboard for sanitary space	L=2,100 mm	—	4pcs/case	
	Special chip saw	Outer diameter 165mm, Number of blades 72		—	1pc	

Special adhesive SE-1, antibacterial, antifungal silicone JK-57□(□= color#), special primer JW-900N, RA-900 is F☆☆☆☆☆

*1) Please refer to "Allocation and primer foundation work" in P5 for the details of primer.

Working tool

Use the following for the working tool.
To avoid chipping, select a new blade.

① Cutting

dustproof circular sawing machine (chip saw, diamond saw)

Cutting blades
at construction

The blade standard varies depending on "outer diameter", "blade thickness" and "number of blades".
Select a blade with "outer diameter" and "blade thickness" fit to the handy saw that you use. Use a tool with as many blades as possible.

special chip saw ZK-9A(φ100×1.1mm×60P), ZK-9B(φ125×1.1mm×80P), ZK-9(φ165×1.6mm×72P)

② Drilling

drill, Hole saw, Router, trimmer

③ Finishing

sandpaper, file, smoothing plane

Checking before installation

1

Checking foundation

Important

First, check whether CERARL can be constructed.

I Checking foundation type

Unsuitable foundation

- Humid foundation
- Direct pasting to ALC framework is disabled.
- Direct pasting to Concrete wall surface is disabled.
- Direct pasting to some coated or some decorated surface is disabled.

For other foundations not corresponding to **“constructible foundations” given below**, be sure to contact us.

Constructible foundations

- Plaster board (more than 12.5mm is recommended)
- Mortar wall (moisture content less than 4.5%, stick strength 1.0/mm², flat surface finished by metal trowel, unevenness less than 2mm)
- Calcium silicate board (more than 6mm, specific gravity more than 0.8 is recommended)
- Luan plywood (more than 9mm is recommended)

Apply special primer **JW-900N, or RA-900** to whole surface.

Precautions

※Select foundation materials and create structures in conformity with laws and regulations such as the Building Standards Act and fire prevention ordinance of your own country.

Fixing foundation materials to framework

1 Light weight steel frame structures

Use frame of 65 type or larger. Fix the foundation materials (plaster boards and so on) at 200 to 300 mm pitch with special screws.
* Securely fix the foundation material edges at frameworks, external and internal corners with special screws.

2 Concrete walls

Mortar walls

Select mortar having good adhesiveness to the RC wall. Finish by masonry trowel to avoid unevenness.

* After the water content of mortar reduces to 4.5% or lower, start construction. (Adhesive strength: 1.0 N/mm² or more)

Wooden furring strips

Fix a furring strip of 24 mm x 45 mm to the framework at 300 mm pitch with anchors, cirques or screws. Fix the foundation materials (plaster boards and so on) with both special screws (at 200 to 300 mm pitch) and adhesive agent.

II Checking foundation construction accuracy

- Check horizontality and verticality of the wall surface.
- Eliminate unevenness from the wall surface.

Checking before installation

2 Checking the wall to be pasted

Construct the foundation structure of the kitchen walls in conformity with laws and regulations of your own country. To prevent extraordinary heat conduction to the CERARL surface, check that the following points are observed.

For a built-in type stove

- If the heat capacity of stove is 4,600kcal, we request to keep the distance of 15 cm or longer between the CERARL surface and the stove side (in japan). If the distance of 15 cm or longer cannot be taken, discoloration or burnt deposits may occur on CERARL due to heat of the stove. To solve this, use a stainless panel (ZK-8 or equivalent). (Occurrence of discoloration or burnt deposits will not affect incombustibility of CERARL.)
- For a stovetop whose grill exhaust port is equipped on the back, exhaust from the grill makes the wall surface hot, which may cause discoloration or burnt deposits. When applying CERARL to a counter having depth less than 65 cm, use a stainless panel.
- Use a stainless panel in cases where the wall surface may possibly become hot.

For a stationary stove

- When the distance between the stationary stove and the wall surface cannot be kept 15 cm or more, use stainless panels (ZK-8 or equivalent) to the side and back.
- * Use stainless panels in conformity with laws and regulations. Confirm the regulations before use. Observe the structure in accordance with the regulations.

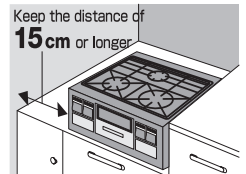

- * Even when all the above conditions are met, carefully examine that flames of the stove will never directly contact CERARL.
- * **The wall surface structure around the stoves is regulated by the fire prevention ordinance or other regulations. Observe the structure in accordance with the regulations.**
- * Do not use CERARL to the portions closed to industrial stoves or cooking appliances.
- * Be sure to avoid direct contact of heated pans to CERARL.

3 Checking fitting

Precautions

- **Do not install CERARL by arranging it side by side,** as it may expand and result in bulging in high humidity; conversely, it may contract and create gaps in low humidity.

① Joiner drawing

(unit: mm)

External corner 	Decorative external corner 	Flat joint 	Sanitary baseboard
Edge corner 	Edge corner for wainscot 	Internal corner 	

Precautions

- To fit with a joiner, insert it into CERARL before construction. Fix the joiner securely using a double-sided tape.
- **For construction around water areas, be sure to pour silicone into the jointer before starting construction.**

② Sealing drawing

③ Batten drawing

④ Ceiling Drawing

Internal corner 	Flat joint 	Batten drawing 	Flat joint 	Wall & Ceiling Joint
----------------------------	-----------------------	---------------------------	-----------------------	-------------------------------------

Note 1: For fitting with batten, use a joint bottom tape with width of 20 mm. If a wider joint bottom tape is used, poor adhesiveness may occur.



Precautions for installation on ceiling

When installing CERARL on the ceiling surface, please pay attention to the following to reduce the risk of falling.

- Be sure to check that the foundation is fixed securely.
- With installing on the ceiling, to reduce **the risk of panels falling**, use panels that are 910 mm x 1,220 mm or smaller, and it is recommended to use a hat typed joiner with a screw.
- To prevent falls, install CERARL on the ceiling before the walls to ensure wall support.
- For ceiling installation, apply the correct amount of special adhesive agent and ensure adequate clamping, ideally with two people.

Application method

1 Allocation and primer foundation work

Observe the following precautions to perform cutting, drilling and notching.



Precautions for Allocation

- Allocate CERARL so that it does not overlap the foundation material joints.
- CERARL cannot be put closely. When constructing with silicone and clearances, keep 3 mm or wider joints. Also, when constructing with joiners, be sure to have a clearance.
- Allocate CERARL to minimize wastes with due considerations of the opening position and appearance.

Foundation for Kitchen

Pre-installed panel fitting

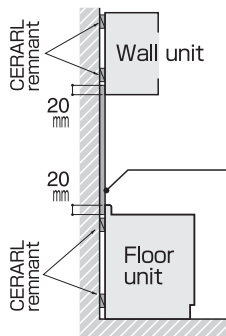

Post-installed panel fitting

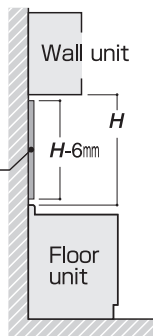

- For the fitting to the pre-installed panel, allocate CERARL by inserting by 20 mm to the hanging shelf and top plate. For the fitting to the post-installed panel, allocate CERARL by removing 3-mm displacement.
- Remove 3-mm displacement for symmetric allocation.

For Mortar wall / Calcium silicate board / Plywood Foundation

Apply primer (AICA AIBON JW-900N or RA-900) to whole surface before applying CERARL.

- Standard applying qty: JW-900N 1kg = for 3'x8' 3~4sht
- RA-900 2kg = for 3'x8' 9~11sht

Precautions

- Use primer (Aica-Aibon JW-900N, RA-900) without dilution.
- Paste CERARL **within 4 hours to 7 days** after applying primer (Aica-Aibon JW-900N: Solvent-based type). Although JW-900N does not contain toluene or xylene, sufficient ventilation is required during application.
- Paste CERARL within 20 days after applying primer (Aica-Aibon RA-900: Aqueous type) and drying it for 24 hours or longer in winter, 12 hours or longer in spring and autumn, and 6 hours or longer in summer as a guideline. Since the drying state varies depending on the environments, be sure to confirm that primer is completely dried and then go to the next process.* Use primer at 5°C or higher temperature

Notching section drawing

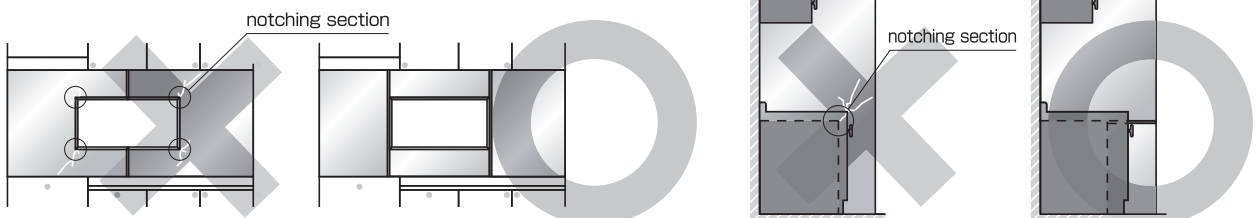

- When a **notching section** is large as shown in the figure above, cracks may occur. (In the case as above, select allocation with multiple pieces instead of notching.)

2

Cutting and machining

Observe the following precautions to perform cutting and machining.

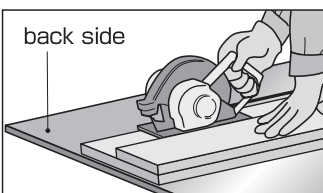
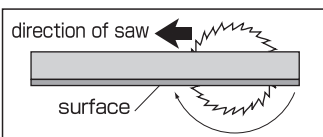

Precautions for Cutting

- To cut CERARL, put it on a hard, heat insulating material with a splint. Be sure to insert the cutter from **the front surface** and take it out from the rear surface. (A protective film is applied to the front surface.)
- Even with a protective film provided, pay a special attention to cut CERARL.

Chamfering

- **Lightly chamfer** a cut section using fine sandpaper fit to the splint.
- For fitting with clearance and fitting with sealing, **lightly chamfer** uncut sections, too.

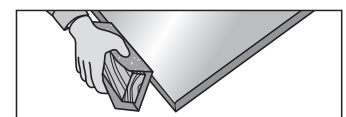

Precautions for drilling and notching

- Before drilling and notching, be sure to drill on the corners from **the front surface** using a cutter with **12φ or more**.
- Burrs and chips generated by cutting may **cause cracks**. **Smooth the cut surface** using sandpaper.

Drilling for socket

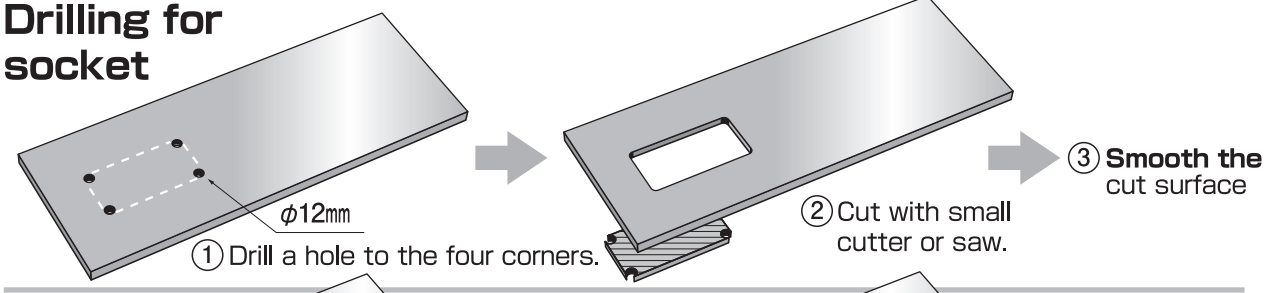

Notching

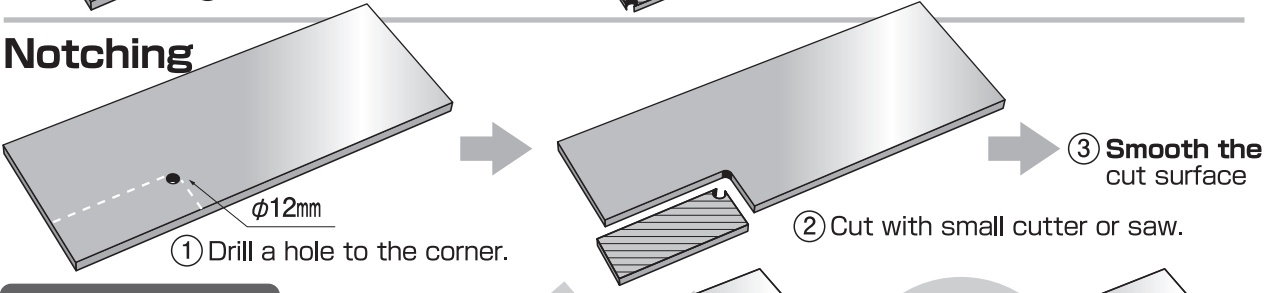

Caution

When **cutting at a pin angle** as shown at right, cracks may occur.

- In the case as shown at upper right, select allocation with multiple pieces instead of notching.

3 Applying special temporary tacking tape and special adhesive agent

Observe the following precautions when applying special temporary tacking tape and special adhesive agent.

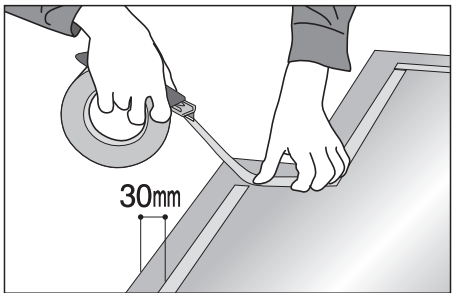

Precautions for tape application

- Space a **30-mm area** at edge of CERARL to apply adhesive agent. Then, paste a temporary tacking tape except for that area.

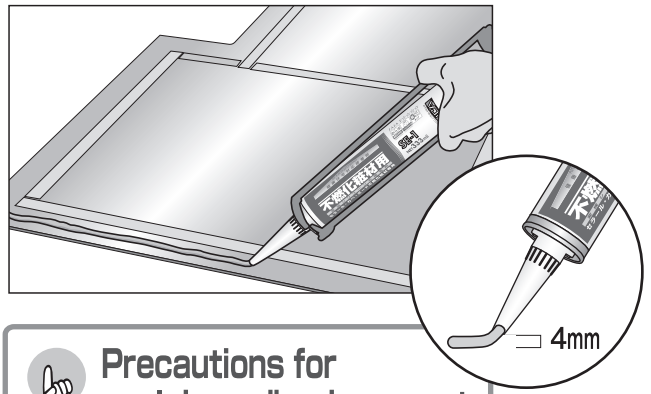

Precautions for applying adhesive agent

- Apply adhesive agent with **4-mm height**.
 - Be sure to apply adhesive agent to **the periphery** of CERARL.
 - The recommended amount for applying AICA Eco Bond SE-1 is one unit for a 910 mm x 2,440 mm area and 1.3 units for a **1,220 mm x 2,440 mm** area. Insufficient application amount may cause peeling or other failures.
 - Paste and crimp CERARL **within 10 minutes** after applying adhesive agent.
- (Precaution for use of special adhesive agent)**
 CERARL **cannot be constructed** at 5°C or lower temperature.

[Standard Application Pattern]



<Standard (3x8)> Be sure to apply adhesive agent linearly at edges.

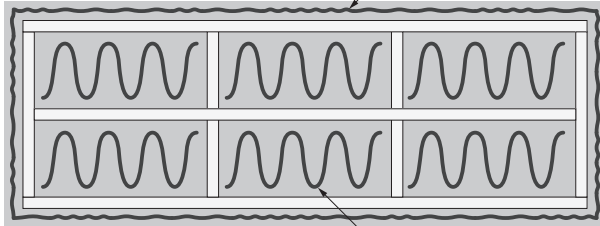

Be sure to apply adhesive agent wavy around the center.

<Standard (4x8)> Be sure to apply adhesive agent linearly at edges.

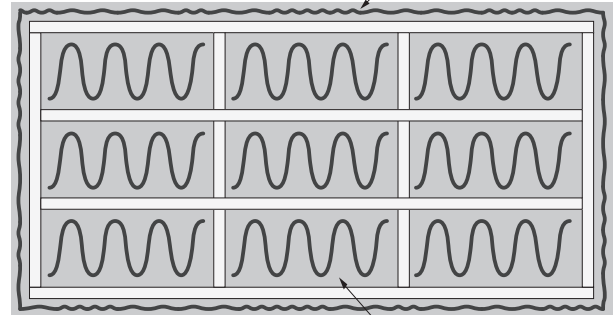

Be sure to apply adhesive agent wavy around the center.

<Drilling for socket> Be sure to apply adhesive agent linearly at edges.

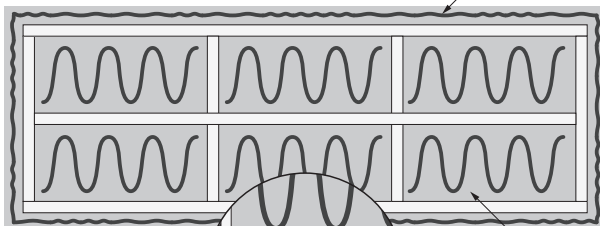

Enlarged drawing of hole

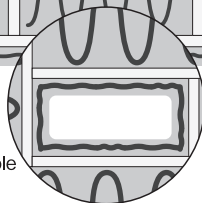

Be sure to apply adhesive agent wavy around the center.

<Notching> Be sure to apply adhesive agent linearly at edges.

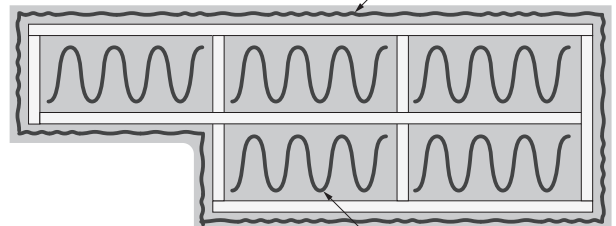

Be sure to apply adhesive agent wavy around the center.

- Reinforce the openings and notches with a temporary tacking tape and adhesive agent. (Take the same measure when pasting a temporary tacking tape and applying adhesive agent to the foundation.)

4

Pasting and crimping

Observe the following precautions to perform pasting and crimping.



Precautions for pasting

- When pasting CERARL, be careful not to generate a float in the center. **Two or more persons are required for pasting.** Concurrently, be careful not to generate distortion at the openings and notches. (This may cause cracking after construction.)
- * Once the temporary tacking tape adheres to the wall surface, it cannot be adjusted.

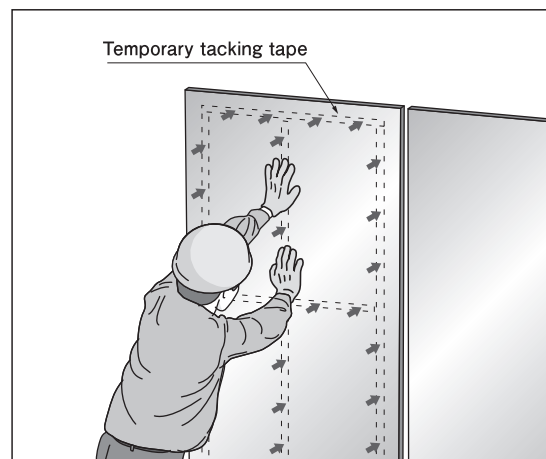

Precautions for crimping

- **Push the temporary tacking tape securely.**
- * Remember that, by pushing the area where adhesive agent is applied, CERARL may be forcedly parted.

5

Sealing

Observe the following procedure for sealing (for silicone finish)

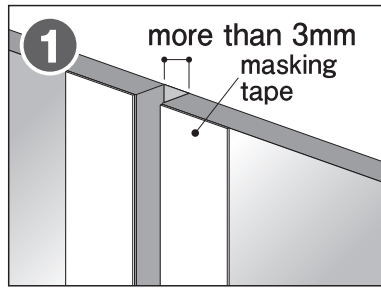

1 Paste a masking tape and fully pour silicone to the end.

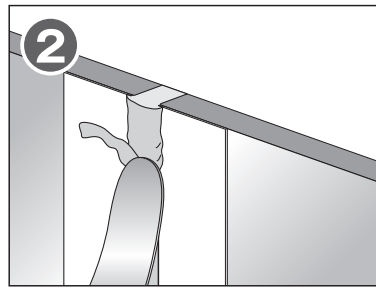

2 Remove excessive silicone using a spatula.

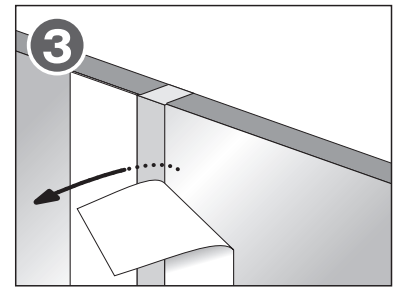

3 Remove the masking tape **gently toward the inside.**

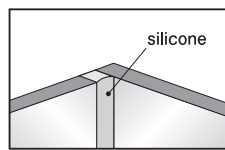
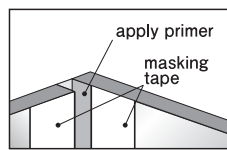

Precautions

Sealing for internal corners

- Since the surface of CERARL has a poor adherence to silicone, be sure to use primer (JW-900N) to apply silicone to the surface of CERARL.

6

Peeling a curing film

After curing for 2 days, peel the protective film from the surface.

Storing stocks

Precautions

- Store stocks in a well-ventilated indoor place, avoiding places exposed to direct sunlight or rain.
- Do not put stocks directly on the ground. Stack them flat on the pallet in a flat place. Never lean stocks against the wall, which may cause warp.

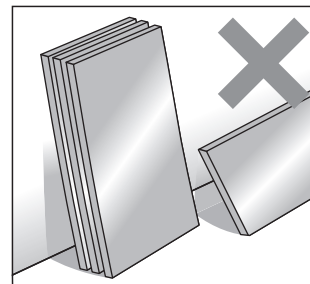
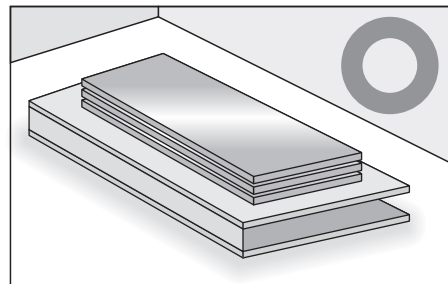

アイカ工業株式会社

AICA KOGYO CO., LTD.

JP Tower Nagoya, 26F, 1-1-1 Meieki, Nakamura-Ku, Nagoya, Aichi, 450-6326, Japan

Website: <https://www.aica.co.jp/>

Petunjuk Pemasangan CERARL untuk Permukaan Rata

- Sebelum memulai, baca petunjuk pemasangan ini untuk pengerjaan yang baik dan benar.
- Petunjuk pemasangan silakan download di www.aica.co.id/produk/cerarl
- Sebelum memulai pemasangan, cek identitas barang dan kondisi barang dari kerusakan yang mungkin terjadi selama pengiriman. Catatan: Kami tidak bertanggung jawab atas kerusakan atau cacat setelah pemasangan.
- CERARL dapat memuai atau menyusut tergantung pada kondisi lingkungan.
Pastikan CERARL dipasang sesuai dengan media yang disarankan (detail lihat halaman 3).
- Permukaan CERARL terdapat plastik pelindung dan nomor identitas barang yang ditempelkan.
Hindari pemasangan CERARL yang bersentuhan langsung dengan area yang berpotensi mudah terjadi pelembaban (hal ini dapat menyebabkan pengelupasan)
- Pada saat memindahkan CERARL, dibutuhkan dua orang atau lebih.
- Pastikan sirkulasi udara cukup selama dan setelah pemasangan.
- Untuk bahan penunjang, seperti perekat khusus, silikon antibakteri/antijamur dan cat primer khusus, lihat informasi detail di Lembar Data Keselamatan Bahan yang akan digunakan.
- Jika disyaratkan, ketika produk ini sudah menjadi limbah, dapat dikategorikan sebagai limbah industri. (sisa potong CERARL, abu CERARL dan plastik pelindung)

Untuk pemasangan Noncombustible Material mengikuti regulasi yang berlaku.



Tindakan Pengamanan

Tindakan pencegahan berikut diberikan untuk mencegah terjadinya cedera dan kecelakaan. Pastikan untuk dipelajari terlebih dahulu.

Tindakan Pencegahan	Kemungkinan Risiko
<ul style="list-style-type: none"> • Jangan gunakan double tape foam dan bahan perekat selain yang sudah direkomendasikan. • Perhatikan media pasang yang akan dipasang CERARL 	<p>Kemungkinan jatuh karena mengelupas</p>
<ul style="list-style-type: none"> • Perhatikan jarak antara CERARL dengan sumber panas. • Area dapur untuk industri memiliki panas yang lebih tinggi dibandingkan area dapur rumah tangga. Tambahkan panel stainless sebagai pelindung. <i>Untuk detailnya lihat Halaman 4.</i> 	<p>Memungkinkan terjadi perubahan warna pada permukaan</p>
<ul style="list-style-type: none"> • Selama pengiriman dan pengerjaan, gunakan alat pelindung diri seperti sarung tangan karet, masker pelindung, dan kaca mata pelindung. • Pastikan pada saat proses potong di lingkungan dengan sirkulasi udara yang baik, gunakan circular saw yang dilengkapi dengan dust collector (penyedot debu). Jika debu menempel di kulit, masuk ke mata, hidung, atau mulut segera bilas dengan menggunakan air bersih. Bila terjadi iritasi lebih lanjut, segera dapatkan perawatan medis. • Hati-hati hasil potongan sisi CERARL dapat melukai tangan, untuk menghindari hal tersebut, haluskan sisi hasil potongan dengan amplas. • Beberapa bahan perekat khusus mengandung bahan yang mudah menguap dan mudah terbakar. Pastikan ventilasi udara terbuka dan jauh dari sumber api saat proses pengerjaan. 	<p>Kemungkinan cedera, gangguan kesehatan, dan kebakaran</p>

Prosedur Pemasangan

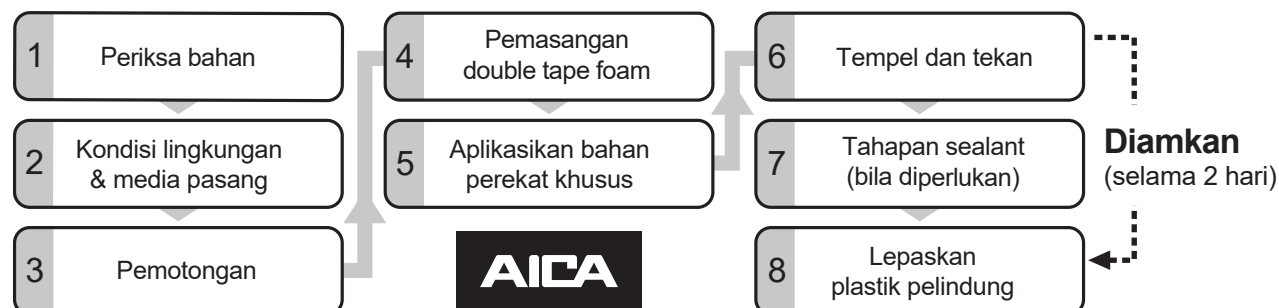

Spesifikasi CERARL

Item	Ukuran (mm)
CERARL	Ketebalan 3 ±0.3
	935×2.455 ±2 (3'×8')

Material	Ukuran	Standar		
Bahan Penunjang	Special adhesive 333 ml/pc	1pc untuk 3'x8' 1 lbr		
	Double tape foam	1roll untuk 3'x8' 1 lbr		
	Package with silicone	Silikon anti bakteri / anti jamur 320 ml/pc	1pc untuk 12~15 m	
	Masking tape	-		
Silikon anti bakteri / anti jamur	320 ml/pc	1pc untuk 12~15 m		
Double tape foam	t1 mm x w20 mm x 10 m/roll	1roll untuk 3'x8' 1 lbr		
Special adhesive	SE-8	333 ml/pc	1pc untuk 3'x8' 1 lbr	
Cat primer untuk Dinding	Pelarut Kimia	1 kg/kaleng	1 kg untuk 3'x8' 3~4 lbr	
	Pelarut Air	1 kg/kaleng	1 kg untuk 3'x8' 4~5 lbr	
Aksesoris (Joiner)	Aluminium	Flat Joint	L = 3.000 mm	-
		Edge/Internal Corner	L = 3.000 mm	-
	ABS	Flat Joint	L = 3.000 mm	-
		Edge/Internal Corner	L = 3.000 mm	-
Common Chip Saw	Diameter luar 165 mm, mata gergaji 60T dan 80T		-	

Alat Kerja

Gunakan alat berikut ini untuk alat kerja. Untuk menghindari grepes, pilih mata gergaji baru.

1 Cutting

mesin gergaji circular saw.

Mata Gergaji	Standar mata gergaji bervariasi tergantung pada diameter luar, ketebalan mata gergaji dan jumlah mata gergaji. Pilihlah mata gergaji dengan diameter luar dan ketebalan mata gergaji yang sesuai dengan mesin circular saw yang Anda gunakan. Untuk hasil yang lebih baik, gunakan mata gergaji sebanyak mungkin.
Special chip saw	φ 100×1.1 mm×60P, φ 125×1.1 mm×80P, φ 165×1.6 mm×72P

2 Drilling

bor, hole saw, router, trimmer

3 Finishing

amplas, kikir, power plane, trimmer

Pengecekan sebelum pemasangan

1 Cek Media Pasang **PENTING**

Pertama, periksa lokasi yang akan digunakan CERARL

I Memeriksa Jenis Media Pasang

Media pasang yang tidak cocok

- Media yang lembab
- Kerangka ALC
- Permukaan dinding beton
- Permukaan *decorative layer*

Media pasang yang dapat dipakai

- Plaster Board (lebih dari 12.5mm direkomendasi)
- Dinding Mortar (kadar air kurang dari 4,5%, kekuatan rekat 1,0 / mm², permukaan rata yang sudah dipleser, ketidakrataan kurang dari 2mm)
- Gypsum (lebih dari 6mm, berat jenis dianjurkan lebih dari 0,8)
- Plywood (dianjurkan lebih dari 9mm)

Oleskan seluruh permukaan dinding dengan cat primer

PERHATIAN

- Pilih bahan media pasang yang dapat dipakai sesuai dengan Standar Regulasi Bangunan dan peraturan pencegahan kebakaran yang berlaku

Mengaplikasi media pasang ke kerangka

- Struktur rangka baja ringan** Gunakan rangka tipe 65 atau lebih besar. Atur bahan media pasang (papan plester dan sebagainya) pada jarak 200 hingga 300 mm dengan sekrup khusus.

- Dinding beton**

Dinding mortar

Pilih mortar yang memiliki daya rekat yang baik pada dinding beton. Pastikan permukaan benar-benar rata.

Wooden furring strips

Pasang strip furring berukuran 24 mm x 45 mm ke rangka pada pitch 300 mm dengan jangkar, lingkaran atau sekrup. Perbaiki media pasang (papan plester dan sebagainya) dengan sekrup khusus (pada jarak 200 hingga 300 mm) dan bahan perekat.

II Memeriksa bidang media pasang

- Memeriksa kerataan permukaan media pasang

2 Memeriksa media pasang yang akan ditempel

Pasang CERARL pada dinding dapur sesuai dengan hukum dan regulasi yang berlaku. Untuk mencegah terjadinya panas berlebih ke permukaan CERARL, periksa dan perhatikan hal-hal berikut.

Untuk kompor tipe built-in

- Jaga jarak minimal 15 cm antara permukaan CERARL dan sisi kompor. Jika jarak kurang dari 15 cm maka perubahan warna dapat terjadi pada CERARL karena ada perpindahan panas dari kompor. Sebagai pencegahan, gunakan panel stainless.
- Untuk kompor yang dilengkapi lubang pembuangan panas di bagian belakang, dapat membuat permukaan dinding menjadi panas, yang dapat menyebabkan perubahan warna.
- Gunakan panel stainless tahan karat jika permukaan dinding berpotensi menjadi panas

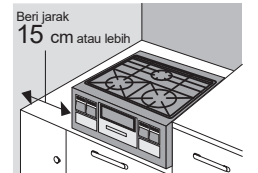

Untuk kompor stasioner

- Ketika jarak antara kompor stasioner dan permukaan dinding tidak dapat dijaga 15 cm atau lebih. Gunakan panel stainless untuk samping dan belakang

* Gunakan panel stainless sesuai dengan hukum dan regulasi yang berlaku.

Ikuti peraturan sebelum digunakan. Perhatikan pemasangan sesuai dengan regulasi yang berlaku.

* Walaupun semua kondisi di atas terpenuhi, pastikan nyala api kompor tidak akan bersentuhan langsung dengan CERARL.

* Struktur permukaan dinding di sekitar tungku diatur oleh regulasi pencegahan kebakaran atau regulasi lainnya. Perhatikan pemasangan sesuai dengan peraturan.

* Jangan gunakan CERARL pada bagian yang dekat dengan kompor industri atau peralatan memasak

* Pastikan hindari kontak langsung panci panas dengan permukaan CERARL

3 Memeriksa Sambungan

1 Gambar joiner

(unit: mm)

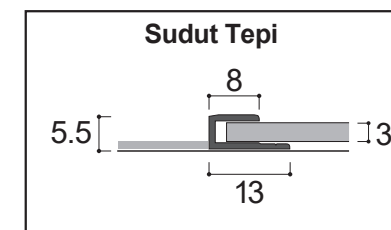

Gambar 3.1

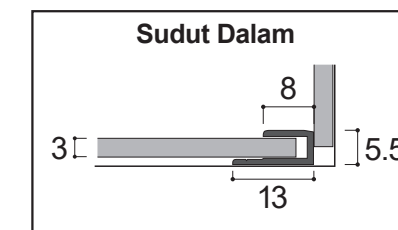

Gambar 3.2

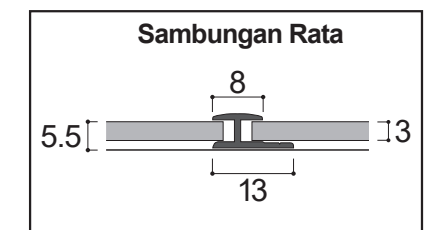

Gambar 3.3

PERHATIAN

- Agar sesuai, sebelum mulai pemasangan, masukkan joiner ke dalam CERARL.
- Untuk pemasangan di sekitar area basah, pastikan untuk menuangkan silikon ke dalam penyambung sebelum memulai pemasangan.

2 Gambar Sealing

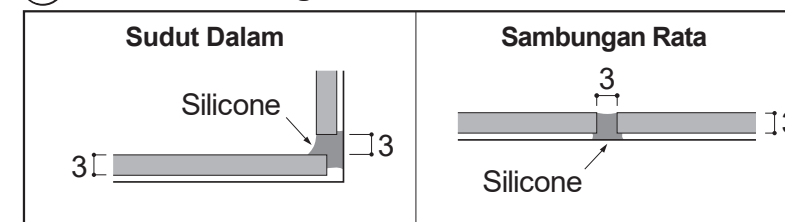

Gambar 3.4

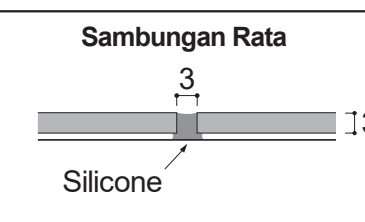

Gambar 3.5

3 Gambar Pola

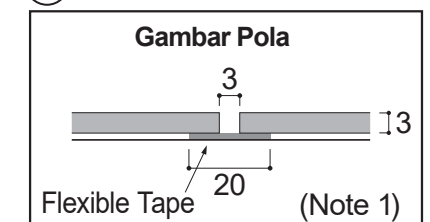

Gambar 3.6

Catatan 1: Untuk pemasangan Cerarl dengan jarak tanpa sealant (lihat Gambar 3.6), dapat menggunakan wallpaper dengan lebar 20 mm. Jika wallpaper yang digunakan lebih lebar, CERARL mudah terkelupas

PERHATIAN

- Beri jarak antar CERARL (min. 3 mm). CERARL dapat memuai pada kelembaban yang tinggi dan menyusut pada kelembaban yang rendah.

Langkah penggunaan

1 Tempat dan pekerjaan pemasangan utama

Perhatikan petunjuk berikut untuk melakukan pemotongan, pengeboran dan notching

Peringatan Penempatan

- Pastikan pemasangan CERARL agar tidak tumpang tindih.
- Untuk penggunaan sealant dan joiner, pastikan memberi jarak minimal 3 mm.

Pemasangan untuk kitchen set

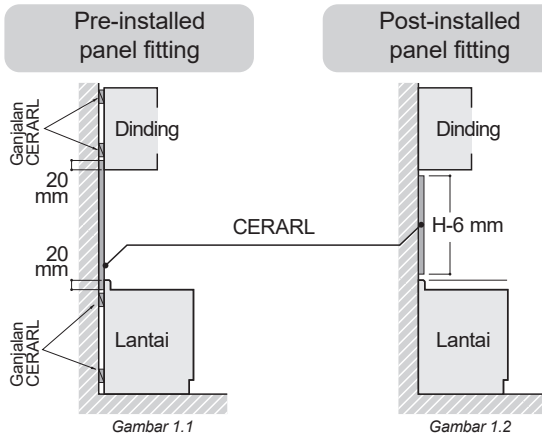

- Gambar 1.1 pastikan CERARL masuk 20 mm ke dalam kitchen set
- Gambar 1.2 beri jarak 3 mm antara kitchen set dan CERARL

Untuk dinding mortar / gypsum media Plywood

Oleskan cat primer ke seluruh permukaan dinding sebelum memasang CERARL

PERHATIAN

- Gunakan cat primer untuk dinding tanpa pengenceran.
- Pasang CERARL dalam waktu 4 jam hingga 7 hari setelah pengaplikasian cat primer untuk dinding
- Karena kondisi pengeringan menyesuaikan lingkungan, pastikan bahwa cat primer benar-benar kering, lalu lanjutkan ke proses selanjutnya.

Notching

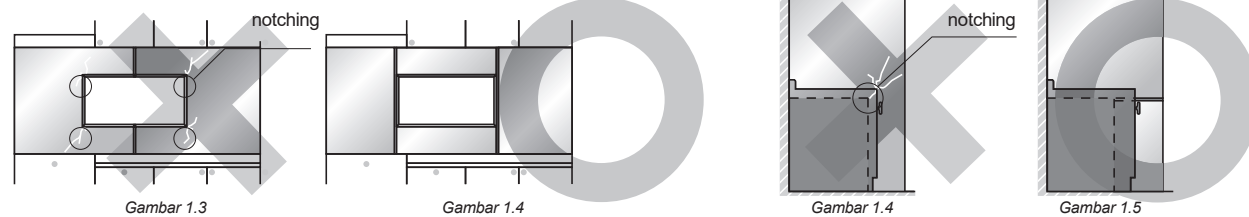

- Retakan dapat terjadi, ketika daerah notching terlalu besar (lihat Gambar 1.3 dan Gambar 1.5). untuk lebih detail lihat di halaman 6.

2 Pemotongan dan Perapihan

Perhatikan petunjuk berikut untuk melakukan proses pemotongan.

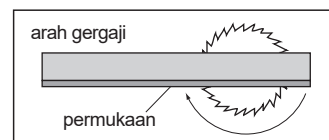

Gambar 2.1

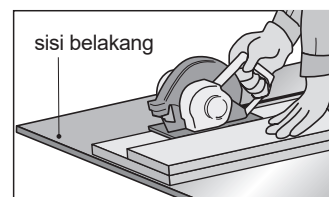

Gambar 2.2

Peringatan untuk Pemotongan

- Pastikan alas untuk memotong CERARL rata. Saat pemotongan, pastikan posisi permukaan CERARL menghadap ke bawah searah mata gergaji.

Perapihan

- Pada hasil pemotongan CERARL, dapat dirapihkan dengan dibubut atau diampelas

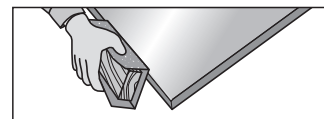

Gambar 2.3

Peringatan untuk pengeboran dan notching

- Sebelum membuat lubang, pastikan untuk mengebor tiap sudut dari permukaan atas menggunakan mata bor berukuran ϕ 12mm atau lebih
- Pada saat pengeboran mungkin akan menyebabkan keretakan. Haluskan permukaan yang retak dengan menggunakan amplas.

Pengeboran untuk stopkontak

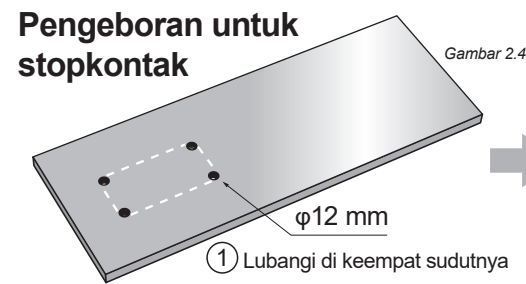

Gambar 2.4

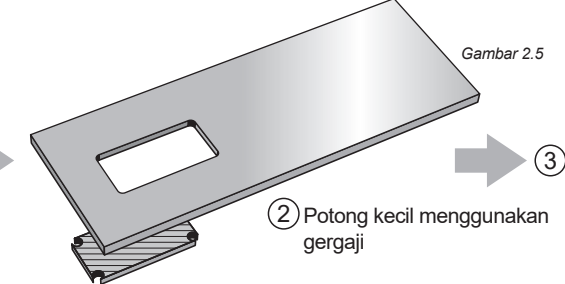

Gambar 2.5

- Haluskan permukaan potong

Notching

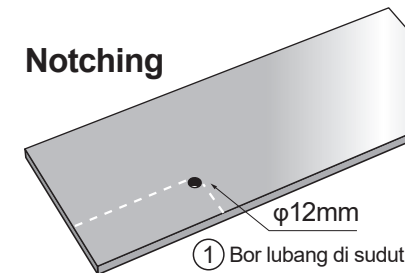

Gambar 2.6

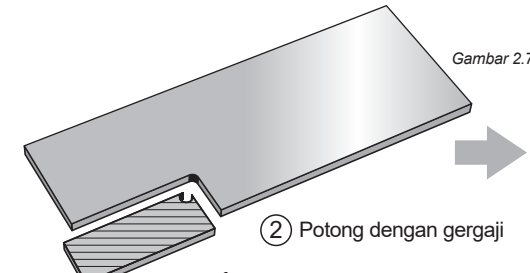

Gambar 2.7

- Haluskan permukaan potong

PERHATIAN

Jika memotong pada sudut ini seperti yang ditunjukkan di gambar sebelah, retakan bisa terjadi

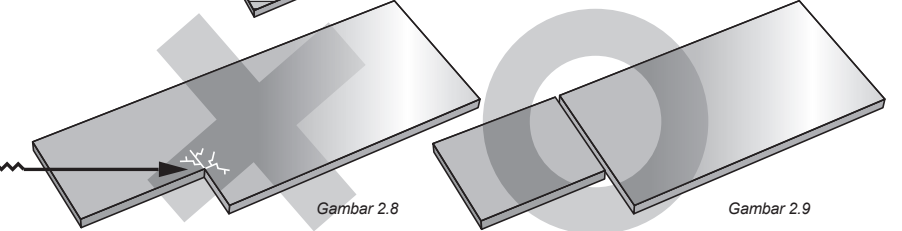

Gambar 2.8

Gambar 2.9

- Untuk menghindari retak sudut pada saat pemotongan, gunakan metode potong pada Gambar 2.9

3 Penggunaan double tape foam dan sealant

Perhatikan instruksi berikut untuk menempelkan double tape foam dan sealant

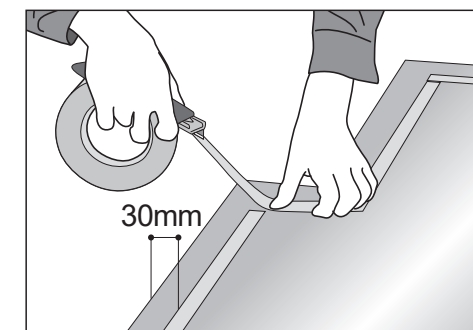

Gambar 3.1

Instruksi penggunaan double tape foam

- Untuk penggunaan double tape foam, beri jarak 30 mm dari tepi CERARL. Kemudian, gunakan double tape foam seperti pada Gambar 3.1

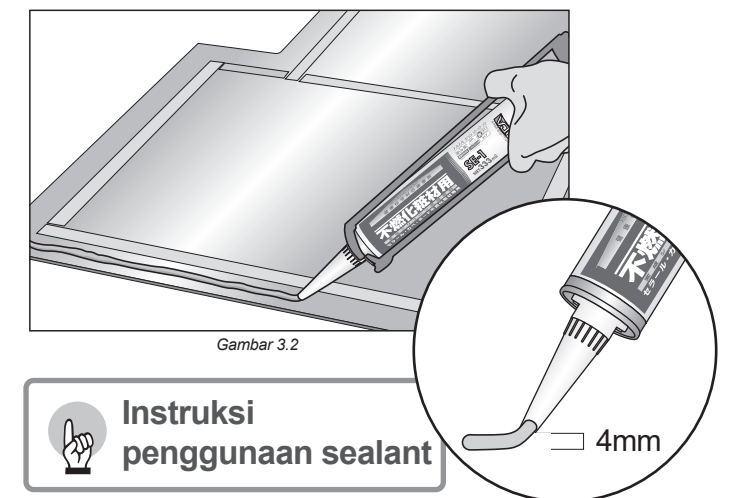

Gambar 3.2

Instruksi penggunaan sealant

- Aplikasikan sealant dengan tinggi 4 mm
- Pastikan untuk menggunakan sealant pada pinggiran CERARL.
- Sebagai panduan, volume aplikasi adalah satu AICA Eco Bond SE-8 untuk satu lembar CERARL 935mm x 2455mm. Volume aplikasi yang tidak mencukupi dapat menyebabkan pengelupasan atau kegagalan lainnya.
- Tempel dan tekan CERARL dalam waktu 10 menit setelah menggunakan AICA Eco Bond SE-8

Standar Penggunaan Sealant



(Pengeboran untuk soket)

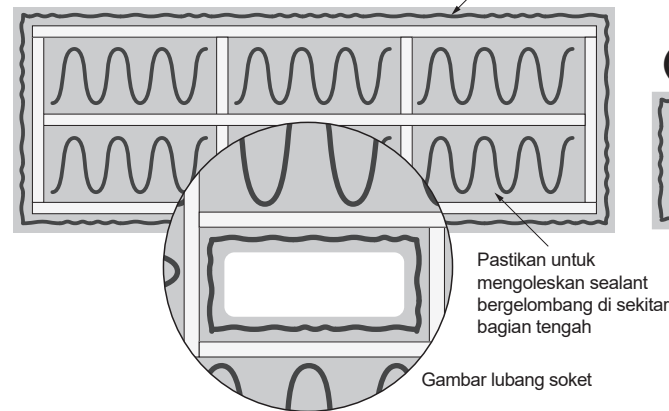

Gambar lubang soket

(Standard)

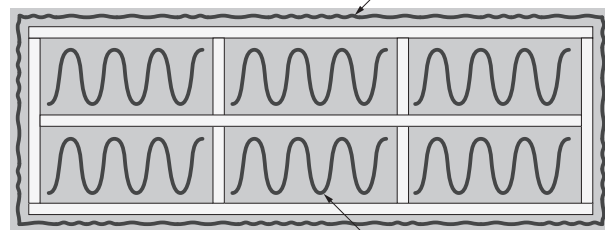

(Notching)

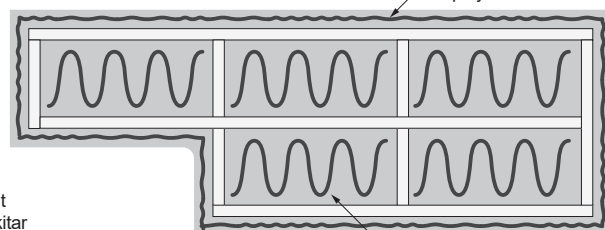

- Pada area notching, tambahkan jumlah double tape foam dan sealant (Ambil ukuran yang sama saat menempelkan double tape foam dan mengoleskan sealant.)

4

Proses Pemasangan

Perhatikan panduan berikut untuk proses pemasangan



Gambar 4.1

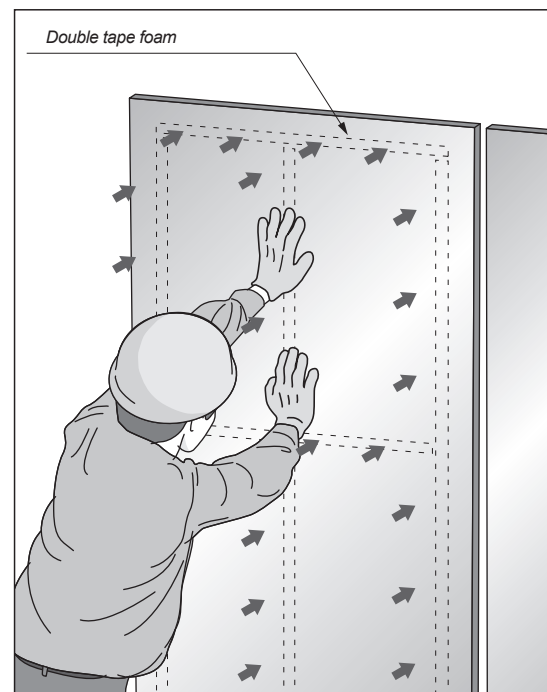

Gambar 4.2

Cara Melekatkan CERARL

- Saat melekatkan CERARL, berhati-hati agar tidak ada gelembung di tengah. **Butuh dua orang untuk melekatkan** secara bersamaan. Berhati-hati agar tidak menimbulkan pergeseran pada saat melekatkan dan notches. (Ini dapat menyebabkan keretakan setelah pemasangan.)

* Setelah double tape foam menempel pada permukaan dinding, double tape foam tersebut tidak dapat disesuaikan.

Cara Menekan CERARL

- Tekan permukaan CERARL pada area yang sudah terdapat double tape foam dengan hati-hati
 - * Perhatian! jangan menekan CERARL pada posisi yang tidak ada double tape foam, karena CERARL dapat bergeser.
 - * Perhatian! lepas plastik pelindung sepanjang sisi CERARL 30 mm sebelum proses sealing.

5

Proses Sealing

Perhatikan proses sealing berikut (untuk lapisan silikon)

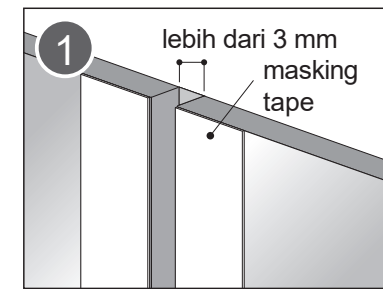

Gambar 5.1

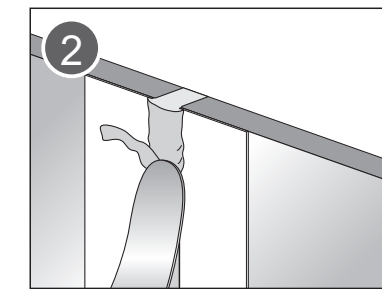

Gambar 5.2

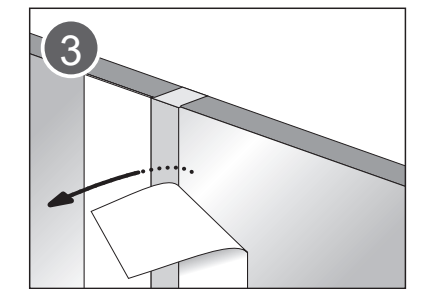

Gambar 5.3

Lekatkan masking tape dan aplikasikan silikon diantara celah CERARL sepenuhnya

Rapihkan silikon yang berlebih

Lepaskan masking tape ke arah dalam sealant dengan hati-hati

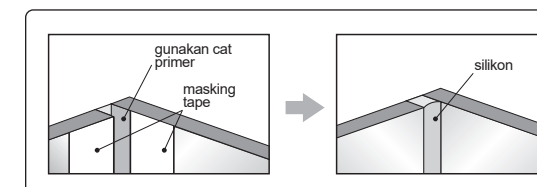

Perhatian Sealing untuk sudut dalam

- Karena permukaan CERARL memiliki daya rekat yang kurang baik terhadap silikon, pastikan untuk menggunakan cat primer terlebih dahulu sebelum mengaplikasikan silikon ke permukaan CERARL

6

Membuka Plastik Pelindung

Setelah didiamkan selama 2 hari, buka plastik pelindung dari permukaan

Penyimpanan CERARL

Perhatian

- Simpan CERARL di dalam ruangan yang berventilasi baik dan hindari terkena sinar matahari langsung atau hujan.
- Jangan diletakkan langsung di tanah/lantai. Tumpuk rata diatas palet di tempat yang rata. Jangan menyandarkan CERARL ke dinding, karena dapat menyebabkan CERARL melengkung.

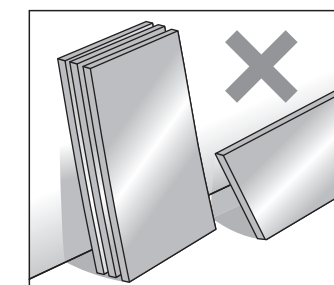
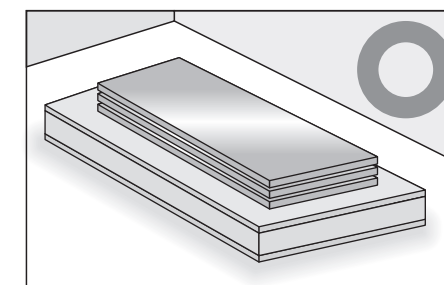

PT Aica Indonesia

Marketing office: Gedung Pakarti Centre 8th Floor,
Jl. Tanah Abang III No. 23, 25, 27, Jakarta Pusat, DKI Jakarta 10160, Indonesia
www.aica.co.id aica.id aica.id AICA Indonesia Official